



RESIDENCE *B*

3 Bedrooms \approx 3 Bathrooms

Interior 2,105 SF | 196 M²

Exterior 652 SF | 61 M²

Total 2,757 SF | 256 M²

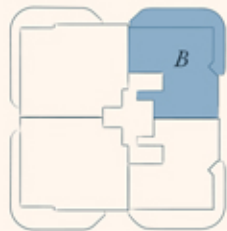

ⓘ THE DIMENSIONS STATED FOR THIS FLOOR PLAN ARE APPROXIMATE BECAUSE THERE ARE VARIOUS RECOGNIZED METHODS FOR CALCULATING THE SQUARE FOOTAGE OF A UNIT. THE SQUARE FOOTAGE STATED HERE IS CALCULATED FROM THE EXTERIOR BOUNDARIES OF THE EXTERIOR WALLS TO THE CENTERLINE OF INTERIOR DEMISING WALLS WITHOUT DEDUCTIONS FOR CUTOUTS, CURVES, OR ARCHITECTURAL FEATURES. THIS METHOD TYPICALLY RESULTS IN QUOTED DIMENSIONS GREATER THAN THE DIMENSIONS THAT WOULD BE DETERMINED BY USING OTHER ACCEPTED METHODS. THE DEFINITION OF "UNIT" AND THE CALCULATION METHOD TO BE RELIED UPON IS SET FORTH BY THE DEVELOPER IN DEVELOPER'S PROSPECTUS WHICH METHOD MAY RESULT IN A SQUARE FOOTAGE CALCULATION LESS THAN THE RESULT OF THE CALCULATION METHOD USED HERE. CONSULT THE DEVELOPER'S PROSPECTUS TO LEARN WHAT IS INCLUDED WITH UNIT PURCHASE AND TO UNDERSTAND UNIT DIMENSIONS.



RESIDENCE C

3 Bedrooms \approx 3 Bathrooms

Interior 2,110 SF | 196 M²

Exterior 662 SF | 61 M²

Total 2,772 SF | 258 M²

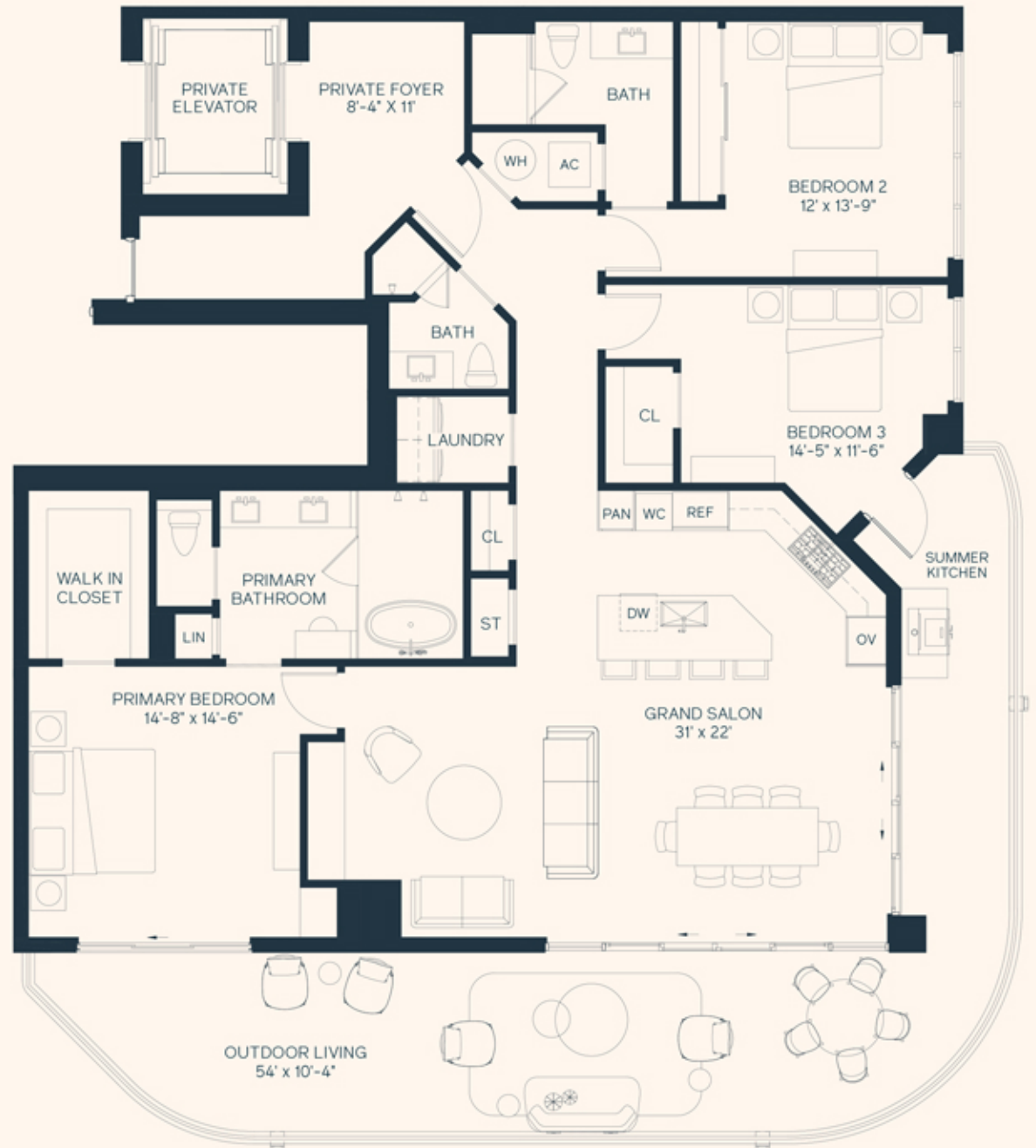
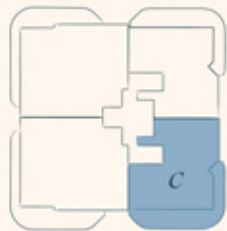

Ⓜ THE DIMENSIONS STATED FOR THIS FLOOR PLAN ARE APPROXIMATE BECAUSE THERE ARE VARIOUS RECOGNIZED METHODS FOR CALCULATING THE SQUARE FOOTAGE OF A UNIT. THE SQUARE FOOTAGE STATED HERE IS CALCULATED FROM THE EXTERIOR BOUNDARIES OF THE EXTERIOR WALLS TO THE CENTERLINE OF INTERIOR DEMISING WALLS WITHOUT DEDUCTIONS FOR CUTOUPS, CURVES, OR ARCHITECTURAL FEATURES. THIS METHOD TYPICALLY RESULTS IN QUOTED DIMENSIONS GREATER THAN THE DIMENSIONS THAT WOULD BE DETERMINED BY USING OTHER ACCEPTED METHODS. THE DEFINITION OF "UNIT" AND THE CALCULATION METHOD TO BE RELIED UPON IS SET FORTH BY THE DEVELOPER IN DEVELOPER'S PROSPECTUS WHICH METHOD MAY RESULT IN A SQUARE FOOTAGE CALCULATION LESS THAN THE RESULT OF THE CALCULATION METHOD USED HERE. CONSULT THE DEVELOPER'S PROSPECTUS TO LEARN WHAT IS INCLUDED WITH UNIT PURCHASE AND TO UNDERSTAND UNIT DIMENSIONS.



RESIDENCE *D*

4 Bedrooms \approx 4 Bathrooms

Interior 2,818 SF | 262 M²

Exterior 721 SF | 67 M²

Total 3,539 SF | 329 M²

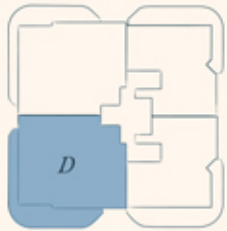

ⓘ THE DIMENSIONS STATED FOR THIS FLOOR PLAN ARE APPROXIMATE BECAUSE THERE ARE VARIOUS RECOGNIZED METHODS FOR CALCULATING THE SQUARE FOOTAGE OF A UNIT. THE SQUARE FOOTAGE STATED HERE IS CALCULATED FROM THE EXTERIOR BOUNDARIES OF THE EXTERIOR WALLS TO THE CENTERLINE OF INTERIOR DEMISING WALLS WITHOUT DEDUCTIONS FOR CUTOUTS, CURVES, OR ARCHITECTURAL FEATURES. THIS METHOD TYPICALLY RESULTS IN QUOTED DIMENSIONS GREATER THAN THE DIMENSIONS THAT WOULD BE DETERMINED BY USING OTHER ACCEPTED METHODS. THE DEFINITION OF "UNIT" AND THE CALCULATION METHOD TO BE RELIED UPON IS SET FORTH BY THE DEVELOPER IN DEVELOPER'S PROSPECTUS WHICH METHOD MAY RESULT IN A SQUARE FOOTAGE CALCULATION LESS THAN THE RESULT OF THE CALCULATION METHOD USED HERE. CONSULT THE DEVELOPER'S PROSPECTUS TO LEARN WHAT IS INCLUDED WITH UNIT PURCHASE AND TO UNDERSTAND UNIT DIMENSIONS.



RESIDENCE A

4 Bedrooms \approx 4 Bathrooms

Interior 2,829 SF | 263 M²

Exterior 691 SF | 64 M²

Total 3,526 SF | 327 M²

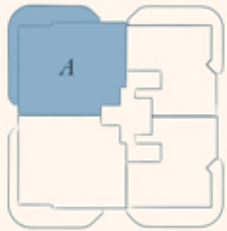

⚠ THE DIMENSIONS STATED FOR THIS FLOOR PLAN ARE APPROXIMATE BECAUSE THERE ARE VARIOUS RECOGNIZED METHODS FOR CALCULATING THE SQUARE FOOTAGE OF A UNIT. THE SQUARE FOOTAGE STATED HERE IS CALCULATED FROM THE EXTERIOR BOUNDARIES OF THE EXTERIOR WALLS TO THE CENTERLINE OF INTERIOR DEMISING WALLS WITHOUT DEDUCTIONS FOR CUTOUTS, CURVES, OR ARCHITECTURAL FEATURES. THIS METHOD TYPICALLY RESULTS IN QUOTED DIMENSIONS GREATER THAN THE DIMENSIONS THAT WOULD BE DETERMINED BY USING OTHER ACCEPTED METHODS. THE DEFINITION OF "UNIT" AND THE CALCULATION METHOD TO BE RELIED UPON IS SET FORTH BY THE DEVELOPER IN DEVELOPER'S PROSPECTUS WHICH METHOD MAY RESULT IN A SQUARE FOOTAGE CALCULATION LESS THAN THE RESULT OF THE CALCULATION METHOD USED HERE. CONSULT THE DEVELOPER'S PROSPECTUS TO LEARN WHAT IS INCLUDED WITH UNIT PURCHASE AND TO UNDERSTAND UNIT DIMENSIONS.



RESIDENCE *B*

3 Bedrooms \approx 3 Bathrooms

Interior 2,105 SF | 196 M²

Exterior 652 SF | 61 M²

Total 2,757 SF | 256 M²

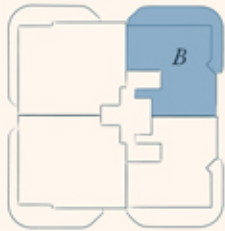

ⓘ THE DIMENSIONS STATED FOR THIS FLOOR PLAN ARE APPROXIMATE BECAUSE THERE ARE VARIOUS RECOGNIZED METHODS FOR CALCULATING THE SQUARE FOOTAGE OF A UNIT. THE SQUARE FOOTAGE STATED HERE IS CALCULATED FROM THE EXTERIOR BOUNDARIES OF THE EXTERIOR WALLS TO THE CENTERLINE OF INTERIOR DEMISING WALLS WITHOUT DEDUCTIONS FOR CUTOUTS, CURVES, OR ARCHITECTURAL FEATURES. THIS METHOD TYPICALLY RESULTS IN QUOTED DIMENSIONS GREATER THAN THE DIMENSIONS THAT WOULD BE DETERMINED BY USING OTHER ACCEPTED METHODS. THE DEFINITION OF "UNIT" AND THE CALCULATION METHOD TO BE RELIED UPON IS SET FORTH BY THE DEVELOPER IN DEVELOPER'S PROSPECTUS WHICH METHOD MAY RESULT IN A SQUARE FOOTAGE CALCULATION LESS THAN THE RESULT OF THE CALCULATION METHOD USED HERE. CONSULT THE DEVELOPER'S PROSPECTUS TO LEARN WHAT IS INCLUDED WITH UNIT PURCHASE AND TO UNDERSTAND UNIT DIMENSIONS.



RESIDENCE C

3 Bedrooms \approx 3 Bathrooms

Interior 2,110 SF | 196 M²

Exterior 662 SF | 61 M²

Total 2,772 SF | 258 M²

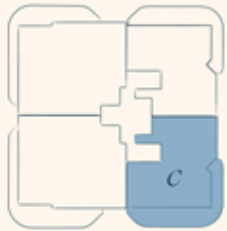

Ⓜ THE DIMENSIONS STATED FOR THIS FLOOR PLAN ARE APPROXIMATE BECAUSE THERE ARE VARIOUS RECOGNIZED METHODS FOR CALCULATING THE SQUARE FOOTAGE OF A UNIT. THE SQUARE FOOTAGE STATED HERE IS CALCULATED FROM THE EXTERIOR BOUNDARIES OF THE EXTERIOR WALLS TO THE CENTERLINE OF INTERIOR DEMISING WALLS WITHOUT DEDUCTIONS FOR CUTOUPS, CURVES, OR ARCHITECTURAL FEATURES. THIS METHOD TYPICALLY RESULTS IN QUOTED DIMENSIONS GREATER THAN THE DIMENSIONS THAT WOULD BE DETERMINED BY USING OTHER ACCEPTED METHODS. THE DEFINITION OF "UNIT" AND THE CALCULATION METHOD TO BE RELIED UPON IS SET FORTH BY THE DEVELOPER IN DEVELOPER'S PROSPECTUS WHICH METHOD MAY RESULT IN A SQUARE FOOTAGE CALCULATION LESS THAN THE RESULT OF THE CALCULATION METHOD USED HERE. CONSULT THE DEVELOPER PROSPECTUS TO LEARN WHAT IS INCLUDED WITH UNIT PURCHASE AND TO UNDERSTAND UNIT DIMENSIONS.



RESIDENCE *D*

4 Bedrooms \approx 4 Bathrooms

Interior 2,818 SF | 262 M²

Exterior 721 SF | 67 M²

Total 3,539 SF | 329 M²

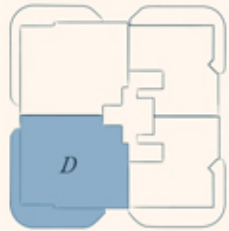

ONEWORLD
PROPERTIES



ⓘ THE DIMENSIONS STATED FOR THIS FLOOR PLAN ARE APPROXIMATE BECAUSE THERE ARE VARIOUS RECOGNIZED METHODS FOR CALCULATING THE SQUARE FOOTAGE OF A UNIT. THE SQUARE FOOTAGE STATED HERE IS CALCULATED FROM THE EXTERIOR BOUNDARIES OF THE EXTERIOR WALLS TO THE CENTERLINE OF INTERIOR DEMISING WALLS WITHOUT DEDUCTIONS FOR CUTOUPS, CURVES, OR ARCHITECTURAL FEATURES. THIS METHOD TYPICALLY RESULTS IN QUOTED DIMENSIONS GREATER THAN THE DIMENSIONS THAT WOULD BE DETERMINED BY USING OTHER ACCEPTED METHODS. THE DEFINITION OF "UNIT" AND THE CALCULATION METHOD TO BE RELIED UPON IS SET FORTH BY THE DEVELOPER IN DEVELOPER'S PROSPECTUS WHICH METHOD MAY RESULT IN A SQUARE FOOTAGE CALCULATION LESS THAN THE RESULT OF THE CALCULATION METHOD USED HERE. CONSULT THE DEVELOPER PROSPECTUS TO LEARN WHAT IS INCLUDED WITH UNIT PURCHASE AND TO UNDERSTAND UNIT DIMENSIONS.